

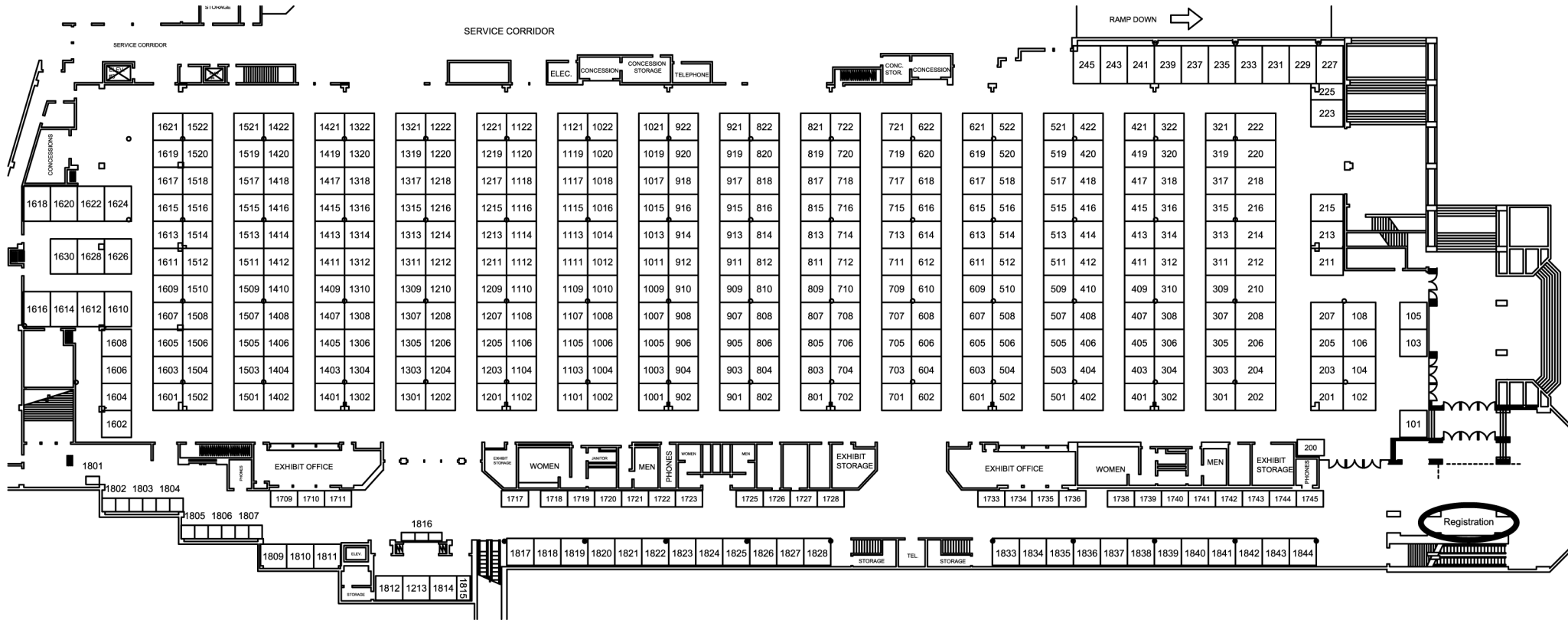

Smoky Mountain Gift Show

GATLINBURG, TENNESSEE

AIRPORT ROAD CONVENTION CENTER LEVEL & HALLWAY





Smoky Mountain Gift Show
GATLINBURG, TENNESSEE

AIRPORT ROAD
GROUND LEVEL
SHOWROOMS AND GALLERY

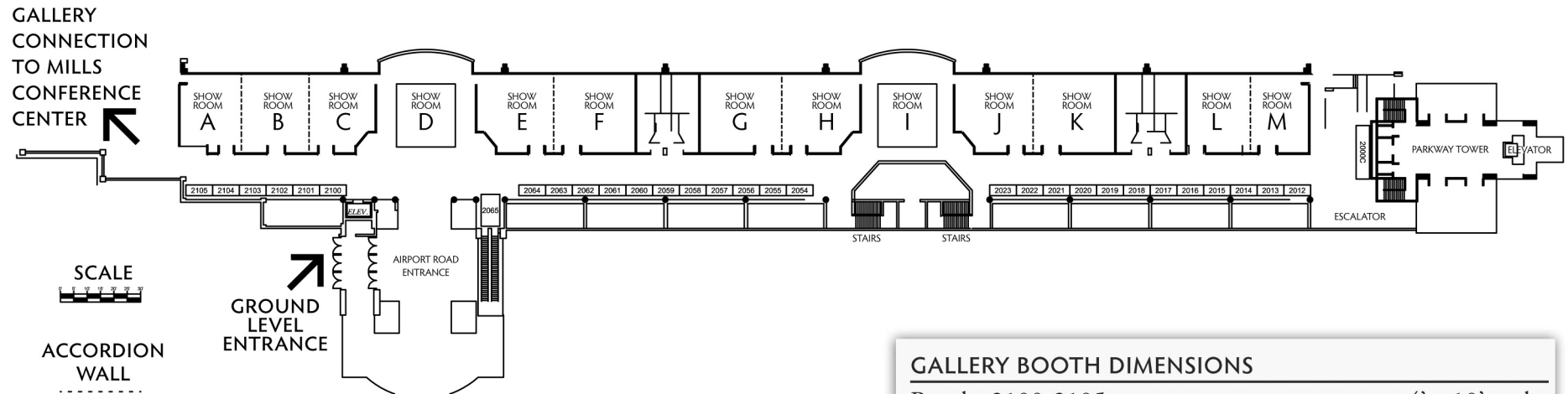

GALLERY BOOTH DIMENSIONS

| | |
|------------------|---------------|
| Booths 2100-2105 | 4' x 10' each |
| Booths 2012-2023 | 5' x 10' each |
| Booths 2054-2064 | 5' x 10' each |
| Booth 2000 | 5' x 20' |

SHOWROOMS GROSS SQUARE FEET

| | | | |
|------------|-----|------------|-----|
| Showroom A | 624 | Showroom H | 702 |
| Showroom B | 598 | Showroom I | 840 |
| Showroom C | 624 | Showroom J | 702 |
| Showroom D | 840 | Showroom K | 780 |
| Showroom E | 702 | Showroom L | 598 |
| Showroom F | 780 | Showroom M | 598 |
| Showroom G | 780 | | |

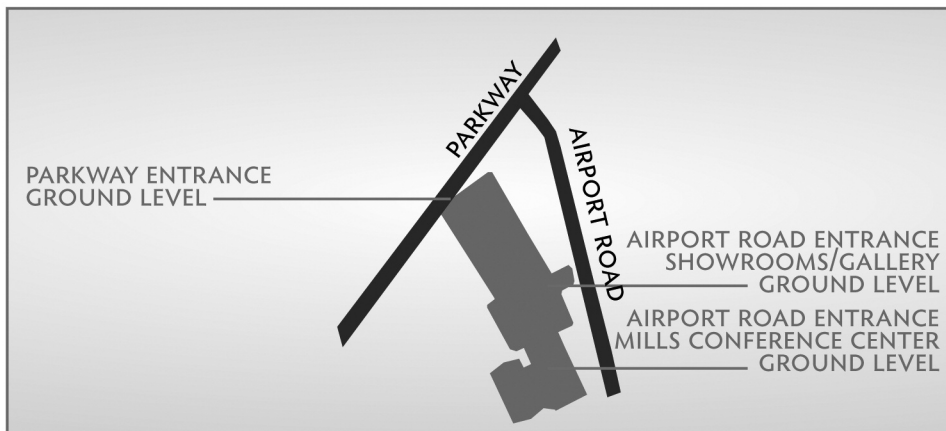

AIRPORT ROAD W. L. MILLS AUDITORIUM & BALLROOM

